

GP993

Shell Treasure Boxes (Pk/24)

MORE IDEAS...



The shell treasure box and lid can also be decorated with glitter, colored rice, beads, and more.

MAKING IT EASY to **SAVE MORE** on your next order!

\$10 OFF
Your Next Order of
only \$39⁰⁰ or more.

Please mention Offer Code: **M2467**

Minimum order \$39 excludes shipping and taxes.

Limit one per order.

May not be combined with other offers
or bid or contract pricing.

See current S&S® catalog or Help at
swww.com for Offer Terms and Conditions.

We reserve the right to terminate this
offer at any time without notice.

S&S Worldwide

© Copyright 2012 S&S® Worldwide Inc. All rights reserved. No part of
this project may be copied or duplicated without the express written
permission of S&S Worldwide.

Call Toll-Free
1-800-243-9232

Online:
SSWW.COM



Customer Service:
1-800-937-3482

Email:
cservice@swww.com

FAX:
1-800-566-6678

Reorder Number

GP993

1.1

S&S Worldwide
MAKING IT EASY
to Help People Play and Learn



Shell Treasure Boxes (Pk/24)

PLEASE READ ALL INSTRUCTIONS BEFORE STARTING



YOUR KIT CONTAINS:

- Boxes
- Shells
- Glue
- Paint
- Sand
- Brushes
- Tablecloth

AGE GROUP: 8 and up
PROJECT TIME: 60 minutes

YOU WILL NEED:

- Clothespins (optional)
- Masking Tape (optional)

INSTRUCTIONS:

1. Take one shell Treasure box lid, fold and glue as shown in Figure A.
2. Take shell treasure box, fold tabs A and B together and glue. Take the large tab and glue over tabs A and B (see Figure B).

HELPFUL HINTS:

Your may wish to use a rubber band or clothespin to clamp the box while the glue is drying.

3. Paint the outside of the box and lid with a color of your choice. Let dry.
4. Mix glue and sand to a pasty consistency, similar to raw cookie dough.

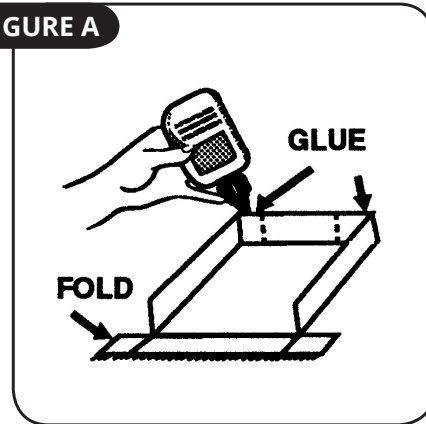
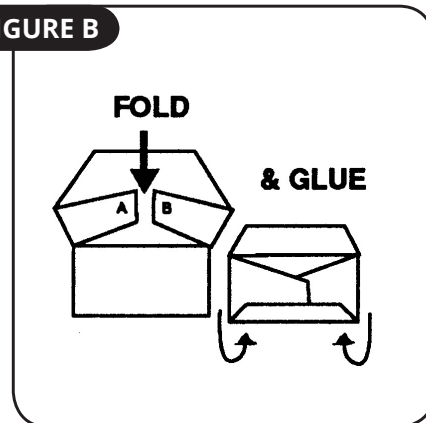
FIGURE A**FIGURE B**

5. Use a craftstick to spread glue mixture onto the lid. Make the sand 1/8" to 1/4" thick on top of the lid. Spread mixture to the edges and wipe any spillovers off the sides of the lid (see Figure C).
6. Take the shells and press into the sand mixture. Let dry.

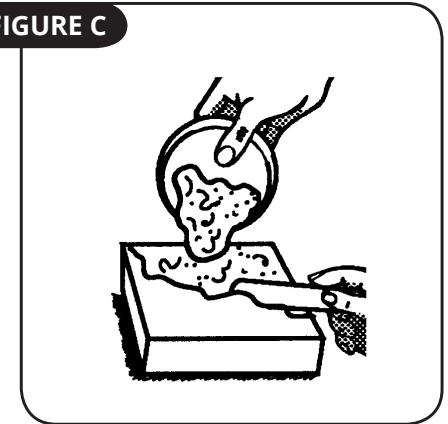
FIGURE C

HELPFUL HINTS: Mask off the lid with tape to keep the sand from running down the side of the lid (see Figure D).

FIGURE D